

Solutions to protect cameras from dirty environment

autoVimation offers various solutions to prevent dust and dirt on the front window of the camera enclosure. So the cameras can be used even under unfavourable conditions.

Air curtains for enclosures with 2" or 3" windows including flow regulation valve, pneumatic fitting for 4mm tube.

- **Intermittent use:** blowing non-sticky dust from the enclosure window.
- **Permanent use:** preventing sticky dust or light moisture mist from reaching the window (Effectiveness depends on weight, speed and direction of particles).



2" air curtain

3" air curtain

For 2" windows

Order Number:
50.100.010

For 3" windows

Order Number:
50.100.011

Additional tube for 2" wind curtain

further increasing efficiency. For diagonal image angles <math>< 40^\circ</math>.

- The tube limits the direction of particle movement and increases the efficiency of the air flow required. This way the air flow can be reduced or the effect of the air curtain increased⁴.

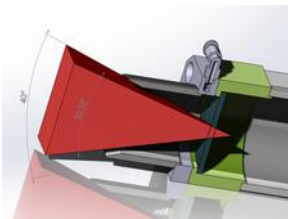

Order Number:
50.100.015

Holder for tube
Order Number:
50.100.016 +
10.040.201

Pneumatic shutter

including cylinder, speed control valves, push in fittings for 4mm tube.

- **Completely seals the front window** during camera intervals.
- The use with wind curtain helps preventing particles reaching the window while the shutter is open.
- **Application example:** Area of a milling machine where part position needs verification prior to machining.



For Salamander or Gecko enclosures

Order Number:
50.200.010



For Orca enclosure with 2" window

Order Number:
50.200.020

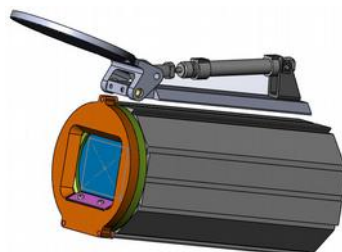

For Orca enclosure with 3" window

Order Number:
50.200.021

IP66 (Nema 4) Laser Enclosures and Triangulation Construction Kit



IP66 protection and robust mounting for cylindrical laser
with standard diameter of 19mm or 20mm

Technical Highlights:

- **Robust build:** aluminium extrusion profile.
- **Small form factor:** easy to integrate into existing machines.
- **Vibration proof laser mounting inside the laser enclosure with good heat dissipation.**
- **The laser enclosure extension allows focal adjustment of laser from the side:** while it is mounted into the laser-enclosure-profile.
- **Compatible to autoVimation's dovetail profiles:** simple set-up of laser-triangulation systems with:
 - **Dovetail profiles (triangulation rail):** easy positioning of the laser and camera enclosure.
 - **Vertical and rotational laser mounts:** allow free adjustment but stay in position once the system has been calibrated.
 - **13mm and 29mm distance pieces:** ensure the optical axes of camera and laser are in the same plane.

Degree of protection	Dimensions	Material details
<ul style="list-style-type: none"> ■ IP66 - Protection from high pressure water jets (Nema 4) 	<ul style="list-style-type: none"> ■ For laser with 19mm or 20mm diameter ■ Enclosure length 120/150/180mm 	<ul style="list-style-type: none"> ■ Enclosure: anodised aluminium ■ Window: BK7, double-sided broadband anti-reflective coating ■ Window seal: Viton ■ Enclosure seal: EPDM ■ Cable gland seal: TPE

Order numbers:

Enclosure length	Laser diameter	Order Number	Enclosure length	Laser diameter	Order Number
120mm	19mm	40.010.020	120mm	20mm	40.010.021
150mm		40.010.030	150mm		40.010.031
180mm		40.010.040	180mm		40.010.041

IP66 (Nema 4) Laser Enclosures and Triangulation Construction Kit

Accessories:

Product	Order Number	Product	Order Number
Adapter bracket from 20mm to 40mm profile to use standard profiles with the laser enclosures	10.049.051	Quick-lock mount for 19mm laser in the Gecko enclosure for special applications	40.010.012
Adapter laser enclosure to 40mm profile same as order number: 40.001.005 without clamp	40.001.004	Laser enclosure extension 25mm allows the focusing of the laser while it is attached in the housing	40.001.025
Vertical laser mount to fix the laser enclosure vertical to a dovetail profile	40.001.005	13mm adapter brings laser (rotational mount) and Orca (orthogonal bracket) in the same optical axis	40.001.007
Rotational laser mount to fix the laser enclosure rotationally to a dovetail profile	40.001.006	29mm adapter brings laser (vertical mount) and Orca (rotational bracket) in the same optical axis	40.001.008

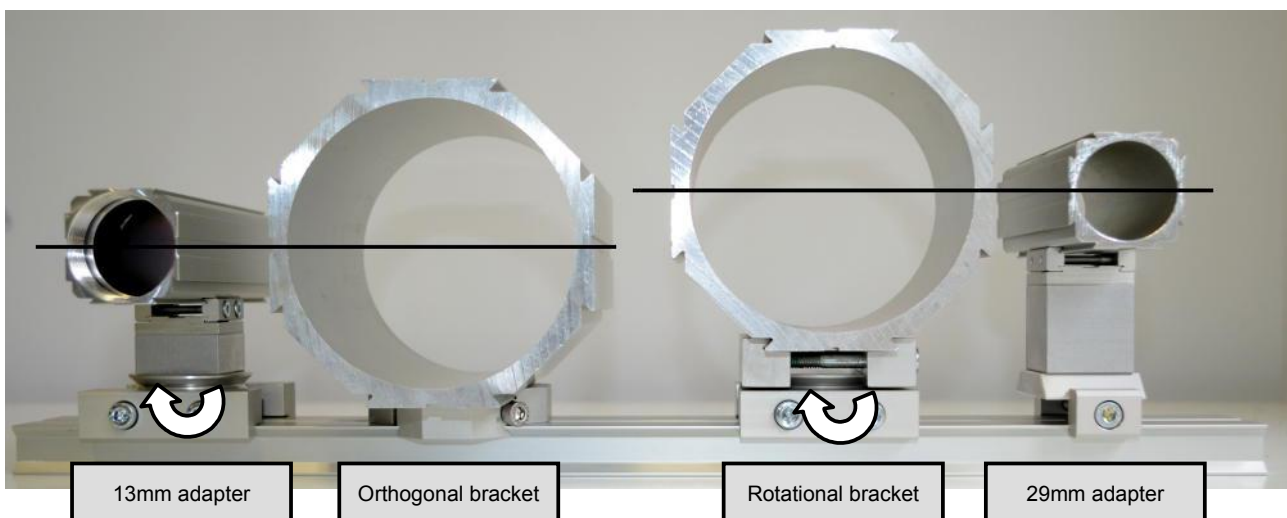

Thanks to the adapters the laser and the camera enclosure can be placed on the same optical axis

© autoVimation 2015 subject to technical change without notice. No liability is accepted for possible errors.

Cooling and heating for autoVimation's camera enclosures



Camera or Laser temperature with water cooling

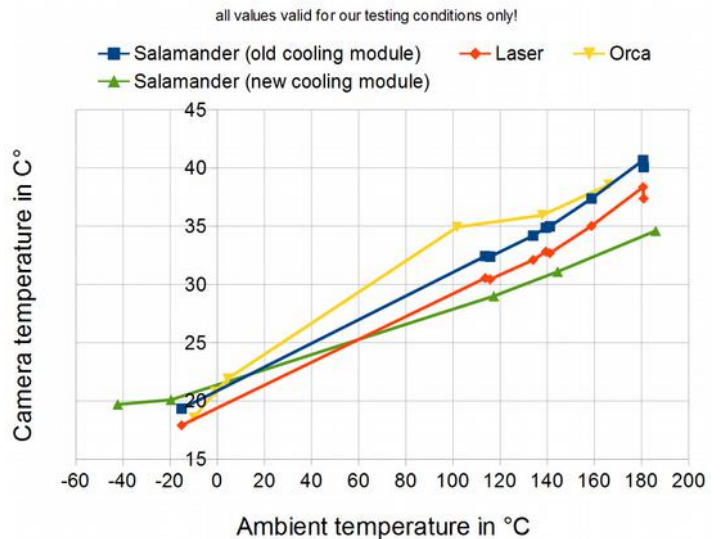

The water cooling unit extends the temperature range of your application by a multiple

Technical Highlights:

- **Simple set-up and operation:** the water cooling module on top of the camera-enclosure is connected with up to 20m long PU tubes to the cooling unit, that is placed in an area with room temperature. Functionality similar to the cooling circuit of a motor vehicle.
- **High temperature range:** autoVimation's water cooling units extend the temperature range of a MV camera from typically 0 to 50°C to -40 to 180°C.
- **Automatic heating and cooling mode:** since the water temperature is drawn to the ambient temperature of the cooling unit.
- **High efficiency:** water as cooling medium allows a more efficient heat transport over longer distances compared to air cooling.
- **Compatible to all Salamander and Orca enclosures:** and autoVimation's Mounting Kits.
- **No cooling fluid is pumped through the enclosure:** thanks to the patented Heat-Guide system, the camera can be cooled through the enclosure wall.
- **No oily compressed air inside the enclosure:** that is often alternatively used for camera cooling.
- **Ideal for hot or cold industrial environments:** if there is a place with moderate temperatures within a 20m radius of the camera enclosure.

Self-contained cooling unit

- **Safety features:** permanent monitoring of camera temperature and water flow and fan operation with emergency shut down function for camera protection in case of any system failure.
- **Included in delivery:** the self-contained cooling unit includes pump (pumping height up to 1,6m), fans and radiator with a maximum cooling power of 1000W, 6m PU water tubing (-20°C to +60°C operating temperature) and 250ml coolant concentrate.
- **The unit can cool up to 5 camera enclosures:** depending on the installation.

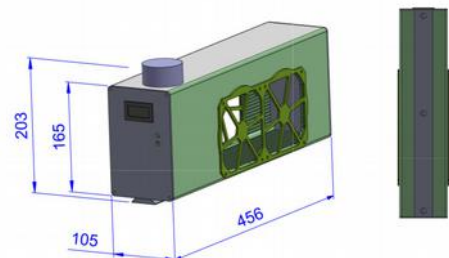

Cooling and heating for autoVimation's camera enclosures

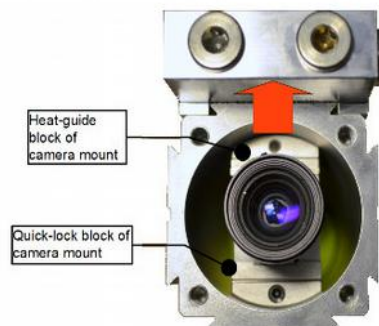
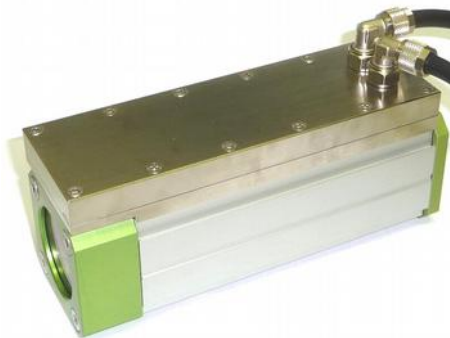

Order numbers:

Product	Order Number
Self contained water cooling unit	60.101.519
Water cooling module for Orca enclosures (starting from enclosure size M)	60.100.009
Water cooling module for direct mount on Salamander and Gecko enclosures (starting from enclosure size M)	60.100.010
Water cooling module base plate for Mammoth enclosures	60.100.020
Water cooling module for Laser enclosures	60.100.030
12V, 20W Power supply	60.010.422
Polyurethan (PU) water tubing if the distance between camera enclosure and cooling unit exceeds 3m (price per meter)	60.101.478
Teflon high temperature water tubing (price per meter)	60.101.477
Additional cooling concentrate (from 10m total tube length)	60.101.333

Temperature controlled heating plate for Salamander and Orca enclosures



The temperature controlled heating plate heats the entire enclosure to max. 20°C. This way it is ensured that the camera cannot overheat and there is no dew-point inside the enclosure. This heating plate maintains the camera temperature typically at around +10°C even at -30°C ambient temperature.

Product	Order Number
For Salamander enclosure, 35W, set to max. 20°C, 24V, power supply separately.	70.100.010
For Orca enclosure, 35W, set to max. 20°C, 24V, power supply separately.	70.100.011

© autoVimation 2012 subject to technical change without notice. No liability is accepted for possible errors.

Illumination Adapters, Mounting Arms and Ring Lights

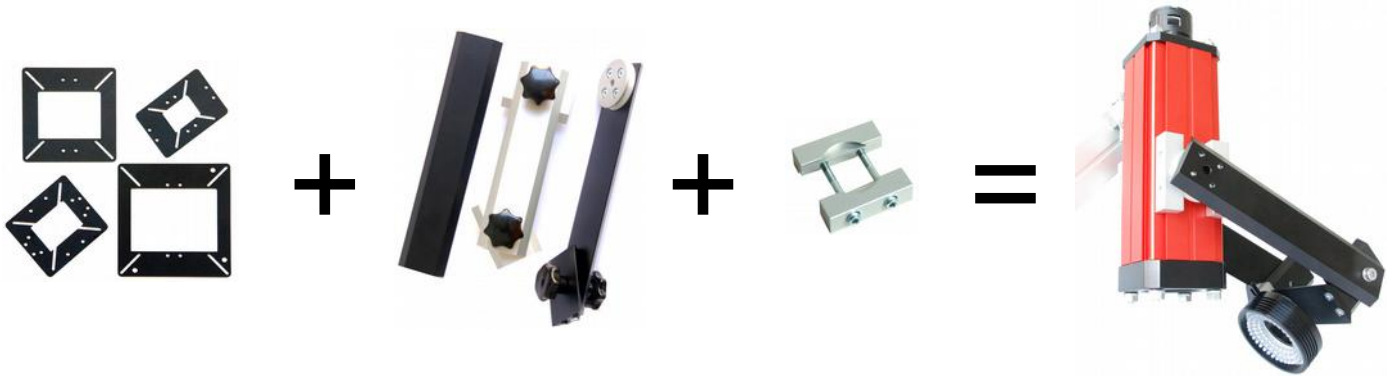

autoVimation's illumination construction kit enables simple and flexible integration of LED-rings

Technical Highlights:

- **Robust build:** aluminium profile.
- **Small form factor:** easy to integrate into existing machines.
- **Flexible positioning:** angle and position.
- **Different arm length available.**
- **Simple adjustment of the working distance.**
- **Compatible with large range of accessories:** variety of mounting and adjustment brackets.
- **No-tool adjustment option:** for laboratory use.

Mounting Arms

Type	Order Number	Type	Order Number
Mounting arm one side, straight, 175mm, mounting tabs for illumination adapter plates	30.009.175	Mounting arm one side, straight, 175mm, mounting tabs for rotational mounting plates	30.010.175



Spider mounting example

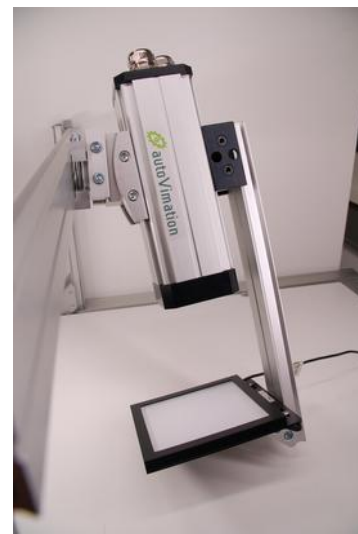

Albatross mounting example

Illumination Adapters, Mounting Arms and Ring Lights

Spider Adapter Plates

Spider 1

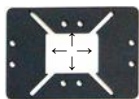

Aperture size 40 x 30 mm (w x h)

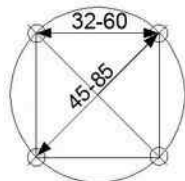

Suitable for hole pattern
square distance:

32 – 60mm \pm 1.25" – 2.36"
diameter:

45 – 85mm \pm 1.77" – 3.35"

Spider 2

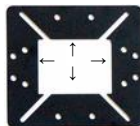

Aperture size 54 x 40 mm (w x h)

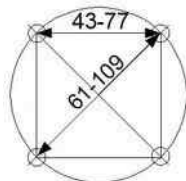

Suitable for hole pattern
square distance:

43 – 77mm \pm 1.70" – 2.36"
diameter:

61 – 109mm \pm 2.40" – 4.29"

Spider 3

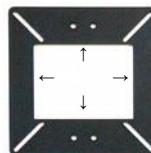

Aperture size 80 x 60 mm (w x h)



Suitable for hole pattern
square distance:

67 – 109mm \pm 2.64" – 4.29"
diameter:

95 – 154mm \pm 3.70" – 6.06"

Spider 4

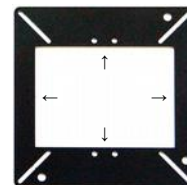

Aperture size 110 x 80 mm (w x h)

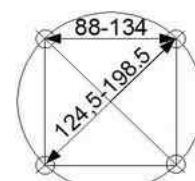

Suitable for hole pattern
square distance:

88 – 134mm \pm 3.46" – 5.28"
diameter:

124.5 – 198.5mm \pm 4.90" – 7.81"

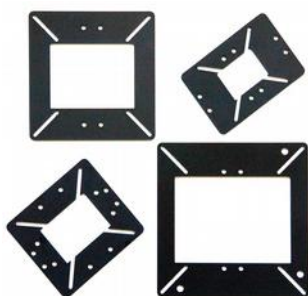

Spider Adapter Plates

Adapter Type	Order Number
Spider 1 – M3, 70 x 98mm	30.150.010
Spider 1 – M4, 70 x 98mm	30.150.011
Spider 2 – M3, 90 x 98mm	30.150.020
Spider 2 – M4, 90 x 98mm	30.150.021
Spider 3 – M3, 120 x 120mm	30.150.030
Spider 3 – M4, 120 x 120mm	30.150.031
Spider 4 – M3, 144 x 144mm	30.150.040
Spider 4 – M4, 144 x 144mm	30.150.041

Albatross Adapter Plates

Adapter Type	Order Number
Albatross 1 – M3, 40 x 58mm	30.200.010
Albatross 1 – M4, 40 x 58mm	30.200.011
Albatross 2 – M3, 40 x 128mm	30.200.020
Albatross 2 – M4, 40 x 128mm	30.200.021
Albatross 3 – M3, 72 x 158mm	30.200.030
Albatross 3 – M4, 72 x 158mm	30.200.031

Illumination Adapters, Mounting Arms and Ring Lights

Ring light mounting options for Orca and Mammoth enclosures

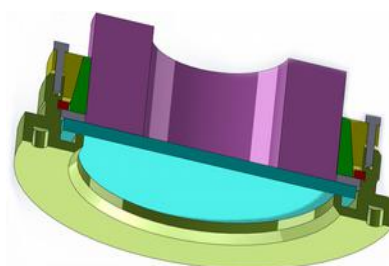
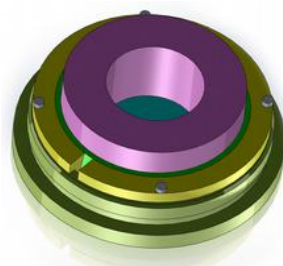

Ring light mount with Spider adapter plate

- **Suitable for Orca 3" window:** 65mm aperture, mounting tabs for Spider Adapter Plate included
- **Flexible solution** (fits most ring lights with diameter of up to 78mm), limited heat dissipation (recommended for strobe use only).

Mounting ring for 65mm ring lights

- **Suitable for Orca 3" window:** 65mm aperture.
- Mounting rings ensure good heat dissipation from the LED light not only to the front lid of the Orca enclosure but also to the enclosure profile. The LED temperature is greatly reduced from over 50°C to 32°C (RL60 @ room temperature)

Matching ring lights

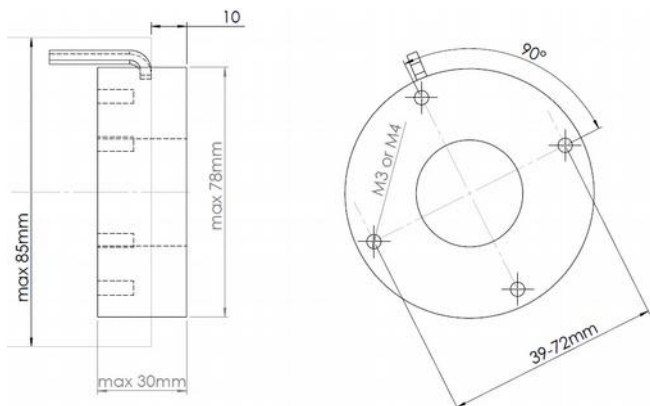

- Every ring light with a regular mounting thread pattern (i.e. 180° or 90° as shown) on a circle of 39 to 72mm.
- Best with an axial cable exit. If the cable exit is radial as shown, the cable should not exit on the first 10mm of the light, where it is inserted into the Orca front lid. In this case the maximum ring light diameter might be less than 78mm to allow for the cable.
- Check if the LED is operated within the permitted temperature range!

Matching ring lights

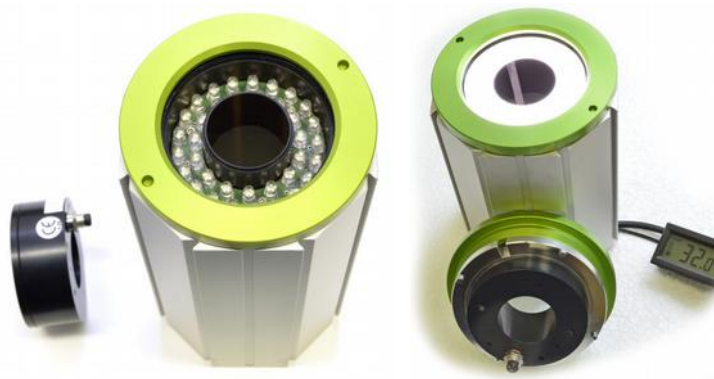

- Any ring light with 65mm external diameter (+/-0,1mm).
- Cable exit axial or radial not at the first 15mm of the LED light.
- 65mm ring lights we sell from a reputable German LED light manufacturer – see the product list on the following page:

Mounting Ring Type	Order Number
Ring Light Mount with Spider Adapter Plate	30.160.010

Mounting Ring Type	Order Number
Mounting Ring for 65mm Ring Light	30.160.020

Illumination Adapters, Mounting Arms and Ring Lights

65mm Ring Lights from autoVimation

Ring Light Type (3-pin connector, 24V/DC)	Order Number
Red, 36 LED, 23°, diffusion disk	35.100.010
Red, 36 LED, 23°, no optics	35.100.011
Red, 36 LED, 23°, directed	35.100.012
Red, 36 LED, 23°, Fresnel lens f=71mm	35.100.013
Red, 36 LED, 23°, Fresnel lens f=230mm	35.100.014
White, 36 LED, 20°, no optics	35.100.015
White, 36 LED, 20°, diffusion disk	35.100.017
White, 36 LED, 20°, directed	35.100.018
White, 36 LED, 20°, Fresnel lens f=71mm	35.100.019
White, 36 LED, 20°, Fresnel lens f=230mm	35.100.020

Ring Light Type (3-pin connector, 24V/DC)	Order Number
White, 36 LED, 15°, no optics	35.100.021
White, 36 LED, 15°, diffusion disk	35.100.022
White, 36 LED, 15°, directed	35.100.023
IR, 36x LED, 6°, directed	35.100.024
IR, 36x LED, 17°, directed	35.100.025
IR, 36x LED, 30°, directed	35.100.026
IR, 36x LED, 6°, no optics, directed	35.100.027
IR, 36x LED, 17°, no optics, directed	35.100.028
IR, 36x LED, 30°, no optics, directed	35.100.029

Flash Module	Order Number
Ub=24VDC / 8A, Uout=48V, U=const., Iges= 3A, 2 channels, dimensions 86x70x60, flash time adjustable in 16 steps tan=5μs to 20ms, duty/cycle=10*tan, trigger 5...24VDC opto isolated, TRGDelay may 20ms	35.150.010

Sensor Cable	Order Number
M8, 3-pin for ring light	35.205.000

The Fresnel lenses direct the centre of the LED illumination to the corresponding working distance. This can increase the light intensity and also may reduce reflection on shiny surfaces. The following images show the effect of the f=71mm and 230mm lenses with a 30° LED opening angle.

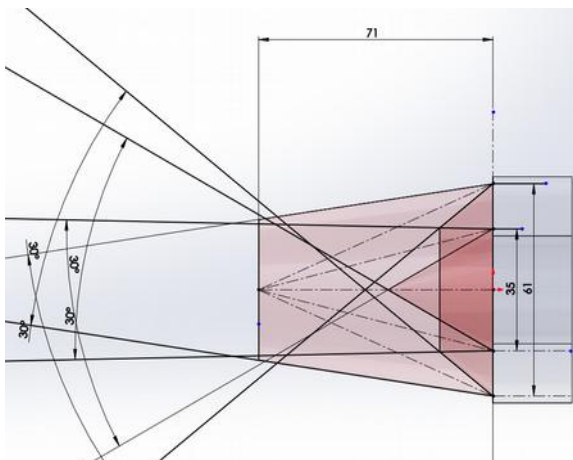

f=71mm, LED angle = 30°

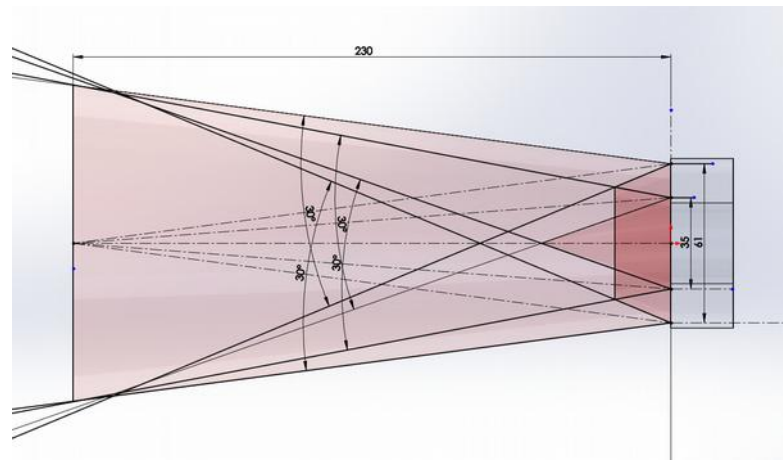

f=230mm, LED angle = 30°