

1" 2 MEGA PIXEL LENS

MACHINE VISION LENS

C-MOUNT
1" 2MP

• 8, 12, 16, 25, 50mm. 5 Lens Series • Compatible with 1" (φ 16mm) Large Format Sensor • High Resolution 2 Megapixel

NEW

V0814-MP

1"

2MP

FIX

MANUAL

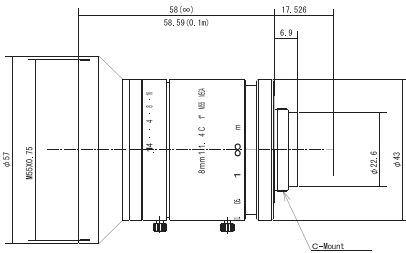

Focal Length	8mm			
Max. Aperture Ratio	1:1.4			
Max. Image Format	12.8mm x 9.6mm (φ 16mm)			
Operation Range	Iris F1.4 - F16.0			
	Focus 0.1m - Inf.			
Control	Iris Manual			
	Focus Manual			
Object Dimension at M.O.D.	19.5cm x 14.2cm 1"			
Angle of View	D	92.4°	82.4°	70.7°
	H	79.7°	1/1.2" 43.9°	2/3" 58.3°
	V	63.0°	47.9°	44.7°
Operating Temperature	-10°C ~ +50°C			

Distortion	1"	-7.07%(y)=8.0)	1/1.2"	-7.30%(y)=6.7)	2/3"	-6.03%(y)=5.5)
Back Focal Length	11.65mm					
Flange Back Length	17.526mm					
Mount	C-Mount					
Filter Size	M55.0 P=0.75mm					
Dimensions	φ 57mm x 58mm					
Weight	250g					

Working Distance (mm)	Optical Magnification	Extension Ring (mm)	Field of View(mm)					
			1"		1/1.2"		2/3"	
			H	V	H	V	H	V
1000	0.007	-	1,947.9	1,423.4	1,712.1	1,075.8	1,333.3	1,000.0
950	0.007	-	1,850.5	1,352.2	1,637.7	1,029.0	1,275.4	956.5
900	0.007	-	1,753.1	1,281.1	1,548.0	972.6	1,205.5	904.1
850	0.008	-	1,655.7	1,209.9	1,467.5	922.1	1,142.9	857.1
800	0.008	-	1,558.3	1,138.7	1,378.1	865.9	1,073.2	804.9
750	0.009	-	1,460.9	1,067.6	1,284.1	806.8	1,000.0	750.0
700	0.009	-	1,363.5	996.4	1,202.1	755.3	936.2	702.1
650	0.010	-	1,266.1	925.2	1,118.8	703.0	871.3	653.5
600	0.011	-	1,168.7	854.0	1,027.3	645.5	800.0	600.0
550	0.012	-	1,071.4	782.9	949.6	596.6	739.5	554.6
500	0.013	-	974.0	711.7	862.6	542.0	671.8	503.8
450	0.015	-	876.6	640.5	774.0	486.3	602.7	452.1
400	0.016	-	779.2	569.4	689.0	432.9	536.6	402.4
350	0.019	-	681.8	498.2	601.1	377.7	468.1	351.1
300	0.022	-	584.4	427.0	516.0	324.2	401.8	301.4
250	0.026	-	487.0	355.9	429.7	270.0	334.6	251.0
200	0.033	-	389.6	284.7	343.5	215.8	267.5	200.6
150	0.044	-	292.2	213.5	258.0	162.1	200.9	150.7
100	0.066	-	194.8	142.3	170.0	103.0	129.6	95.4

Field of View = CCD Size / Optical Magnification

NEW

V1214-MP

1"

2MP

FIX

MANUAL

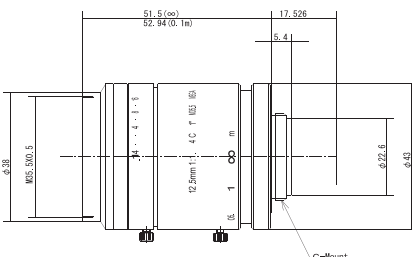

Focal Length	12.5mm			
Max. Aperture Ratio	1:1.4			
Max. Image Format	12.8mm x 9.6mm (φ 16mm)			
Operation Range	Iris F1.4 - F16.0			
	Focus 0.1m - Inf.			
Control	Iris Manual			
	Focus Manual			
Object Dimension at M.O.D.	11.9cm x 8.8cm 1"			
Angle of View	D	67.6°	58.0°	48.4°
	H	56.5°	1/1.2" 49.6°	2/3" 39.1°
	V	42.5°	31.7°	29.5°
Operating Temperature	-10°C ~ +50°C			

Distortion	1"	-5.93%(y)=8.0)	1/1.2"	-4.9%(y)=6.7)	2/3"	-3.63%(y)=5.5)
Back Focal Length	12.55mm					
Flange Back Length	17.526mm					
Mount	C-Mount					
Filter Size	M35.5 P=0.5mm					
Dimensions	φ 38mm x 51.5mm					
Weight	175g					

Working Distance (mm)	Optical Magnification	Extension Ring (mm)	Field of View(mm)					
			1"		1/1.2"		2/3"	
			H	V	H	V	H	V
1000	0.011	-	1,192.7	877.6	1,056.1	663.6	822.4	616.8
950	0.011	-	1,133.1	833.7	1,000.0	628.3	778.8	584.1
900	0.012	-	1,073.4	789.8	949.6	596.6	739.5	554.6
850	0.013	-	1,013.8	746.0	896.8	563.5	698.4	523.8
800	0.013	-	954.2	702.1	843.3	529.9	656.7	492.5
750	0.014	-	894.5	658.2	790.2	496.5	615.4	461.5
700	0.015	-	834.9	614.3	738.6	464.1	575.2	431.4
650	0.017	-	775.3	570.4	684.9	430.3	533.3	400.0
600	0.018	-	715.6	526.6	631.3	396.7	491.6	368.7
550	0.020	-	656.0	482.7	579.5	364.1	451.3	338.5
500	0.022	-	596.4	438.8	525.6	330.2	409.3	307.0
450	0.024	-	536.7	394.9	474.8	298.3	369.8	277.3
400	0.027	-	477.1	351.0	421.6	264.9	328.4	246.3
350	0.031	-	417.5	307.2	368.1	231.3	286.6	215.0
300	0.036	-	357.0	262.7	314.8	197.8	245.1	183.8
250	0.043	-	298.2	219.4	263.4	165.5	205.1	153.9
200	0.054	-	238.5	175.5	210.4	132.2	163.9	122.9
150	0.072	-	178.9	131.6	158.0	99.3	123.1	92.3
100	0.107	-	119.3	87.8	104.3	64.1	80.1	59.5

Field of View = CCD Size / Optical Magnification



1" 12 MEGAPIXEL LENS

MACHINE VISION LENS

- 8, 12, 16, 25, 50mm. 5 Lens Series
- Compatible with 1" (φ 16mm) Large Format Sensor
- High Resolution 2 Megapixel

NEW

V1614-MP

- 1"
- 2MP
- FIX
- MANUAL

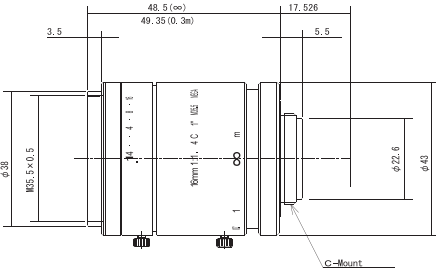

Focal Length	16mm			
Max. Aperture Ratio	1:1.4			
Max. Image Format	12.8mm x 9.6mm (φ 16mm)			
Operation Range	Iris	F1.4 - F16.0		
	Focus	0.3m - Inf.		
Control	Iris	Manual		
	Focus	Manual		
Object Dimension at M.O.D.	25.2cm x 18.7cm 1"			
Angle of View	D	54.4°	46.2°	38.3°
	H	1" 44.3°	1/1.2" 39.3°	2/3" 30.3°
	V	33.6°	24.9°	23.2°
Operating Temperature	-10°C ~ +50°C			

Distortion	1"	3.84%(y=-8.0)	1/1.2"	-3.0%(y=-6.7)	2/3"	-2.24%(y=-5.5)
Back Focal Length	12.14mm					
Flange Back Length	17.526mm					
Mount	C-Mount					
Filter Size	M 35.5 P=0.5mm					
Dimensions	φ 38mm x 48.5mm					
Weight	170g					

Working Distance (mm)	Optical Magnification	Extension Ring (mm)	Field of View(mm)					
			1"		1/1.2"		2/3"	
			H	V	H	V	H	V
1000	0.015	-	840.4	622.5	743.4	467.1	579.0	434.2
950	0.016	-	798.4	591.3	706.3	443.8	550.0	412.5
900	0.017	-	756.4	560.2	668.6	420.1	520.7	390.5
850	0.018	-	714.3	529.1	631.3	396.7	491.6	368.7
800	0.019	-	672.3	498.0	594.7	373.7	463.2	347.4
750	0.020	-	630.3	466.9	556.7	349.8	433.5	325.1
700	0.022	-	588.3	435.7	518.4	325.7	403.7	302.8
650	0.023	-	546.3	404.6	482.9	303.4	376.1	282.1
600	0.025	-	504.2	373.5	444.9	279.5	346.5	259.8
550	0.028	-	462.2	342.4	407.9	256.3	317.7	238.3
500	0.031	-	420.2	311.2	370.5	232.8	288.5	216.4
450	0.034	-	378.2	280.1	334.3	210.1	260.4	195.3
400	0.038	-	336.2	249.3	296.6	186.4	231.0	173.2
350	0.044	-	294.1	217.9	259.8	163.2	202.3	151.7
300	0.051	-	252.1	186.7	221.2	137.0	170.7	127.2
250	0.070	1.0	182.4	136.8	161.0	101.1	125.4	94.0
200	0.090	1.5	142.9	107.3	126.3	79.3	98.3	73.7
150	0.124	2.0	103.4	77.6	91.4	57.4	71.1	53.4
100	0.200	3.0	63.9	48.0	56.4	35.5	44.0	33.0

Field of View = CCD Size / Optical Magnification

NEW

V2514-MP

- 1"
- 2MP
- FIX
- MANUAL

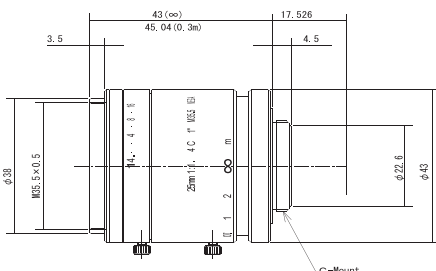

Focal Length	25mm			
Max. Aperture Ratio	1:1.4			
Max. Image Format	12.8mm x 9.6mm (φ 16mm)			
Operation Range	Iris	F1.4 - F16.0		
	Focus	0.3m - Inf.		
Control	Iris	Manual		
	Focus	Manual		
Object Dimension at M.O.D.	16.1cm x 11.9cm 1"			
Angle of View	D	36.6°	30.7°	25.2°
	H	1" 29.3°	1/1.2" 25.9°	2/3" 20.2°
	V	22.0°	16.3°	15.1°
Operating Temperature	-10°C ~ +50°C			

Distortion	1"	-3.14%(y=-8.0)	1/1.2"	-2.2%(y=-6.7)	2/3"	-1.48%(y=-5.5)
Back Focal Length	15.71mm					
Flange Back Length	17.526mm					
Mount	C-Mount					
Filter Size	M35.5 P=0.5mm					
Dimensions	φ 38mm x 43mm					
Weight	150g					

Working Distance (mm)	Optical Magnification	Extension Ring (mm)	Field of View(mm)					
			1"		1/1.2"		2/3"	
			H	V	H	V	H	V
1000	0.024	-	536.3	401.7	472.8	297.1	368.2	276.2
950	0.025	-	509.5	382.5	450.2	282.9	350.6	263.0
900	0.027	-	482.6	362.3	426.4	267.9	332.1	249.1
850	0.028	-	455.8	341.6	402.1	252.7	313.2	234.9
800	0.030	-	429.0	322.2	379.2	238.3	295.3	221.5
750	0.032	-	402.2	301.9	355.4	223.3	276.7	207.6
700	0.034	-	375.4	281.5	331.4	208.2	258.1	193.6
650	0.037	-	348.6	261.6	307.9	193.5	239.8	179.8
600	0.040	-	321.8	241.2	283.9	178.4	221.1	165.8
550	0.043	-	295.0	221.2	260.4	163.6	202.8	152.1
500	0.048	-	268.1	201.3	236.9	148.9	184.5	138.4
450	0.053	-	241.3	181.1	213.2	134.0	166.0	124.5
400	0.060	-	214.5	160.8	189.3	118.9	147.4	110.6
350	0.068	-	187.7	140.8	165.7	104.1	129.0	96.8
300	0.080	-	160.9	119.2	141.2	87.6	109.1	81.3
250	0.106	2.5	120.7	90.6	106.6	67.0	83.0	62.3
200	0.135	3.5	95.1	71.3	84.0	52.8	65.4	49.0
150	0.184	4.5	69.5	52.2	61.4	38.6	47.8	35.9
100	0.291	7.5	43.9	32.9	38.8	24.4	30.2	22.7

Field of View = CCD Size / Optical Magnification

1" 2 MEGA PIXEL LENS

MACHINE VISION LENS

C-MOUNT
1" 2MP

- 8, 12, 16, 25, 50mm. 5 Lens Series
- Compatible with 1" (φ 16mm) Large Format Sensor
- High Resolution 2 Megapixel

NEW

V5014-MP

1"

2MP

FIX

MANUAL

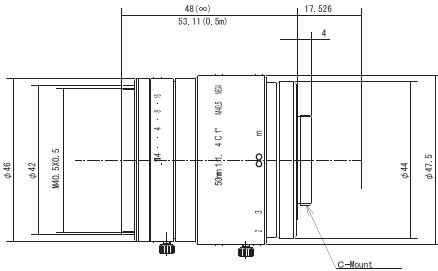

Focal Length	50mm			
Max. Aperture Ratio	1:1.4			
Max. Image Format	12.8mm x 9.6mm (φ 16mm)			
Operation Range	Iris F1.4 - F16.0			
	Focus 0.5m - Inf.			
Control	Iris Manual			
	Focus Manual			
Object Dimension at M.O.D.	12.6cm x 9.4cm 1"			
Angle of View	D	18.0°	15.1°	9.1°
	H	14.5°	12.8°	7.3°
	V	10.9°	8.1°	5.5°
Operating Temperature	-10°C ~ +50°C			

Distortion	1"	0.82%(y=8.0)	1/1.2"	0.7%(y=6.7)	2/3"	0.51%(y=5.5)
Back Focal Length	14.55mm					
Flange Back Length	17.526mm					
Mount	C-Mount					
Filter Size	M40.5 P=0.5mm					
Dimensions	φ 46mm x 48mm					
Weight	200g					

Working Distance (mm)	Optical Magnification	Extension Ring (mm)	Field of View(mm)					
			1"		1/1.2"		2/3"	
			H	V	H	V	H	V
1000	0.051	-	251.5	188.2	222.1	139.5	172.9	129.7
950	0.054	-	239.0	178.8	211.0	132.6	164.3	123.2
900	0.057	-	226.4	169.4	199.9	125.6	155.6	116.7
850	0.060	-	213.8	160.0	188.8	118.6	147.0	110.2
800	0.064	-	201.2	150.6	177.7	111.6	138.4	103.8
750	0.068	-	188.7	141.2	166.6	104.7	129.7	97.3
700	0.073	-	176.1	131.8	155.5	97.7	121.1	90.8
650	0.078	-	163.5	122.3	144.3	90.7	112.4	84.3
600	0.085	-	150.9	112.9	133.2	83.7	103.8	77.8
550	0.093	-	138.3	103.5	122.1	76.7	95.1	71.3
500	0.102	-	125.8	94.1	110.9	69.5	86.2	64.2
450	0.113	5.5	113.0	84.7	99.7	62.7	77.7	58.3
400	0.128	6.5	100.2	75.1	88.4	55.6	68.9	51.6
350	0.147	7.5	87.4	65.5	77.1	48.5	60.1	45.1
300	0.172	8.5	74.6	55.9	65.8	41.4	51.3	38.4
250	0.207	10.5	61.8	46.3	54.5	34.3	42.5	31.9
200	0.261	13.0	49.0	36.7	43.2	27.2	33.7	25.3
150	0.354	17.5	36.2	27.1	31.9	20.1	24.9	18.7
100	0.548	25.5	23.4	17.5	20.6	13.0	16.1	12.1

Field of View = CCD Size / Optical Magnification

MEGA PIXEL VARI-FOCAL LENS

MACHINE VISION LENS

C-MOUNT
2/3" 1MP

- Useful range of focal length for Machine Vision: f=12mm - 36mm
- Locking set screws for zoom, focus and iris

M3Z1228C-MP

2/3"

1MP

VARI

MANUAL

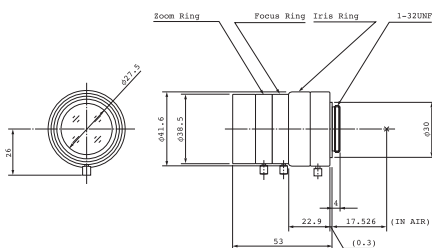

Focal Length	12mm - 36mm		
Max. Aperture Ratio	1:2.8		
Max. Image Format	8.8mm x 6.6mm (φ 11mm)		
Operation Range	Iris F2.8 - F16C		
	Focus 0.2m - Inf.(Tele) 0.05m - Inf.(Wide)		
	Zoom 12mm - 36mm		
Control	Iris Manual		
	Focus Manual		
	Zoom Manual		
Object Dimension at M.O.D.	12mm 4.0(H)cm x 3.0(V)cm 2/3"		
	36mm 4.8(H)cm x 3.6(V)cm 2/3"		
Angle of View	D	50.4° - 16.8°	37.5° - 12.5°
	H	2/3" 41.0° - 13.6°	1/2" 30.2° - 10.0°
	V	31.2° - 10.4°	22.8° - 7.6°
Operating Temperature	-10°C ~ +50°C		

Effective Lens Aperture	Front	φ 27.2mm			
	Rear	φ 12.1mm			
Back Focal Length	Tele	13.5mm			
	Wide	14.7mm			
Distortion	Tele	2/3"	+3.5%(y=5.5)	1/2"	+1.7%(y=4.0)
	Wide		-2.6%(y=5.5)		-1.9%(y=4.0)
Flange Back Length	17.526mm				
Mount	C-Mount				
Filter Size	M35.5 P=0.5mm				
Dimensions	φ 41.6mm x 53				
Weight	105g				

※ Please note M3Z1228C-MP is produced to order